

## DELIVERY PROGRAM 2025

Roof Drainage System

Roof System Accessories

Architectural Details and Flashings

Façade Systems

Perforated Profiles and Mesh

Sheets and Coils

Profiling Machines and Sheet Metal Tools

The prices do not include VAT or any customs duties

# THE MOST SUSTAINABLE CONSTRUCTION ZINC IN THE WORLD.

prePATINA

ECO ZINC

**prePATINA becomes prePATINA ECO ZINC  
with 50% less carbon.**

With prePATINA ECO ZINC, we are taking a big step forward on the path to decarbonisation. We are the first manufacturer of construction zinc to reduce carbon emissions by 50%. We make sustainability real: with real renewable energies – certified and without compensation.



EXTREMELY  
DURABLE



PRACTICALLY  
MAINTENANCE-  
FREE



100%  
RECYCLABLE



NATURALLY  
SUSTAINABLE



blue-grey



graphite-grey

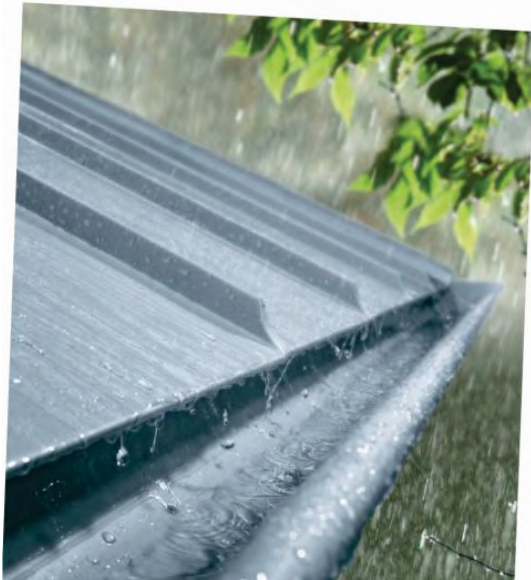

## CONCRETE CARBON SAVINGS

prePATINA ECO ZINC

**12.0 kg carbon**

per m<sup>2</sup> of standing seam roof

**3.6 kg carbon**

per running metre of gutter

This delivery program is only commercial information and is an invitation to conclude a contract within the meaning of art. 71 of the Polish Civil Code and cannot be considered an offer within the meaning of art. 66 sec. 1 of the same Civil Code.

All sales are carried out by the network of commercial companies - RHEINZINK distributors.

Version: 1/2025

Please ask your RHEINZINK distributors for the current version.



## ROOF DRAINAGE SYSTEM

- NUMBER 1 FOR TILE ROOFS IN EUROPE
- METAL THICKNESS IN ACCORDANCE WITH PN-EN 612
- WIDE RANGE OF MATCHED ACCESSORIES
- SELF-RESTORING PATINATED SURFACE

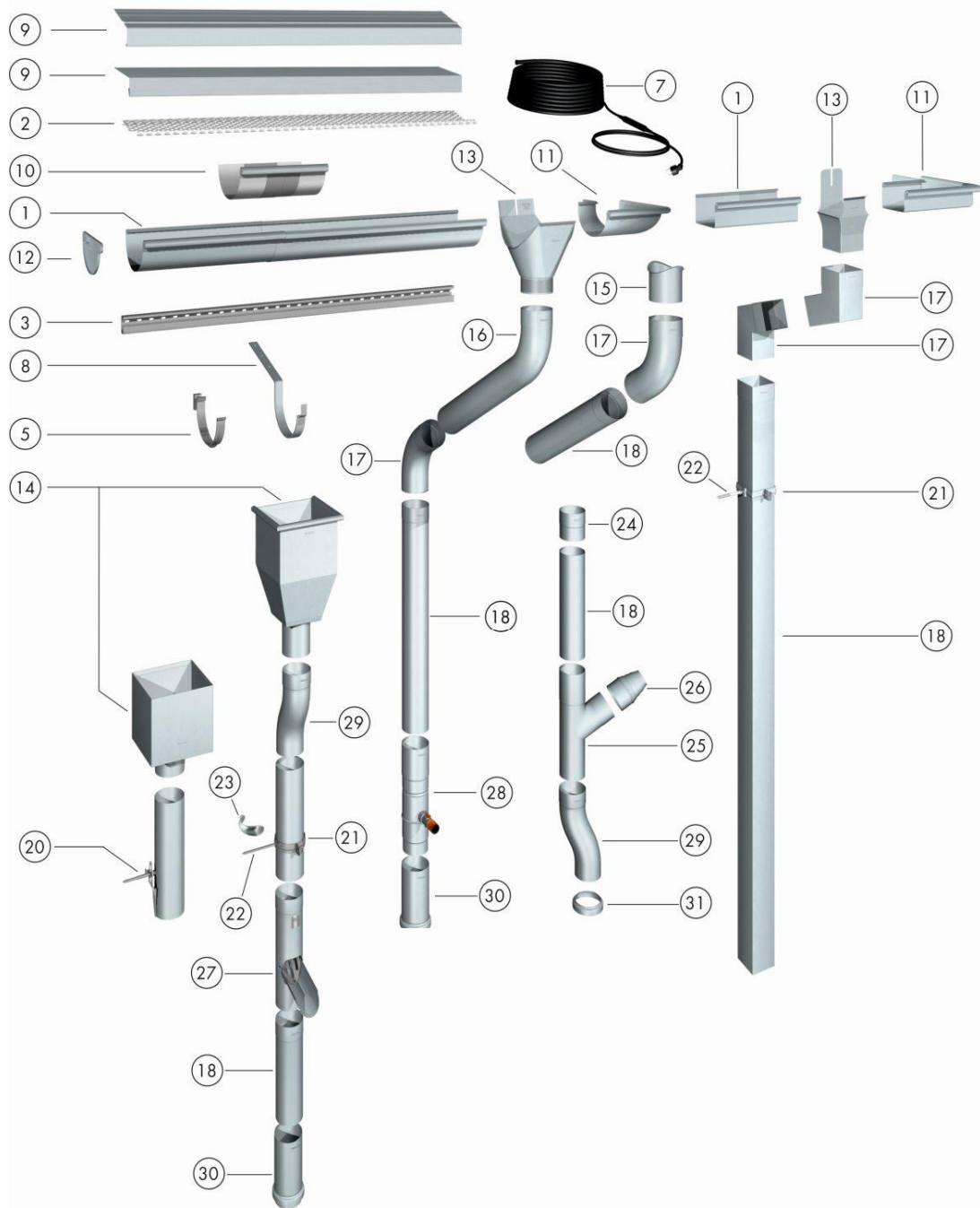

- |                            |                      |                           |                         |
|----------------------------|----------------------|---------------------------|-------------------------|
| 1 Gutter                   | 10 Expansion element | 17 Downpipe               | 24 Pipe reducer         |
| 2 Leaf guard               | 11 Corner            | 18 Univ. downpipe bracket | 25 Water diverter       |
| 3 Snap-lock fixing rail    | 12 Stop end          | 19 Downpipe bracket       | 26 Water butt connector |
| 5 Snap-lock gutter bracket | 13 Plug-in outlet    | 20 Bolt                   | 27 Offset               |
| 7 Gutter heating           | 14 Hopper head       | 21 Half bead              | 28 Cover sleeve         |
| 8 Gutter bracket           | 15 Spigot outlet     | 22 Pipe socket            | 29 Standpipe collar     |
| 9 Eaves strip              | 16 Pipe elbow        | 23 Pipe branch            |                         |

**Halfround gutter**, length 3 m, thickness in accordance with the requirements of class A according to EN 612 standard

size mm	CLASSIC walzblank		prePATINA blaugrau		prePATINA schiefergrau filmed	
	art. no./thickness mm		art. no./thickness mm		art. no./thickness mm	
<b>400 (192)</b>	111 1017 /0,80		411 1017 /0,80		3611 1017 /0,80 *	
<b>333 (153)</b>	111 1061 /0,70		411 1061 /0,70		3611 1061 /0,70	
<b>280 (127)</b>	111 1074 /0,70		411 1074 /0,70		3611 1074 /0,70	
<b>250 (105)</b>	111 1108 /0,65		411 1089 /0,70		3611 1089 /0,70 *	

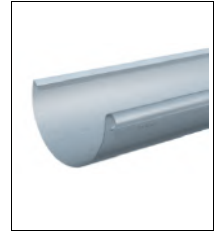

**Box gutter**, length 3 m, thickness in accordance with the requirements of class A according to EN 612 standard

size mm	thickness mm	CLASSIC walzblank		prePATINA blaugrau		prePATINA schiefergrau filmed	
		art. no.		art. no.		art. no.	
<b>400 (150)</b>	0,80	-	-	411 3011		-	-
<b>333 (120)</b>	0,70	111 3058		411 3058		3611 3058	



**Balcony gutter**, length 3 m, thickness in accordance with the requirements of class A according to EN 612 standard

size mm	length mm	CLASSIC walzblank		prePATINA blaugrau		prePATINA schiefergrau	
		art. no./thickness mm		art. no./thickness mm		art. no.	
<b>200 (70)</b>	3 000	111 3200 /0,70 *		411 3200 /0,70 *		-	-

**Snap-lock fixing rail, aluminium (C-shape)**

length mm	cross-section, mm	art. no.		
3 000	48×18	993 6003		



**Round downpipe**, welded (seam without overlap), thickness in accordance with the requirements of EN 612 standard

size mm	CLASSIC walzblank		prePATINA blaugrau		prePATINA schiefergrau	
	art. /length m /th. mm		art. /length m /th. mm		art. /length m /th. mm	
<b>150</b>	112 1071 /2 /0,70 *		412 1071 /2 /0,70 *		-	-
<b>120</b>	112 1611 /2 /0,70		412 1611 /2 /0,70		3512 1611 /2 /0,70 *	
<b>100</b>	112 1662 /3 /0,65		412 1658 /3 /0,70		3512 1612 /2 /0,70	
<b>80</b>	112 1664 /3 /0,65		412 1660 /3 /0,70		3512 1614 /2 /0,70	
<b>60</b>	112 1624 /2 /0,65 *		412 1625 /2 /0,70 *		3512 1625 /2 /0,70 *	



**Box downpipe**, length 2 m, welded (seam without overlap), thickness in accordance with the requirements of EN 612 standard

size mm	thickness mm	CLASSIC walzblank		prePATINA blaugrau		prePATINA schiefergrau filmed	
		art. no.		art. no.		art. no.	
<b>120</b>	0,80	-	-	412 4009		-	-
<b>100</b>	0,70	112 4051		412 4051		3512 4051	

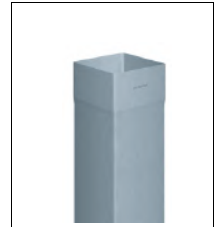

**Halfround expansion element**, length 260 mm

size mm	thickness mm	CLASSIC walzblank		prePATINA blaugrau		prePATINA schiefergrau	
		art. no.		art. no.		art. no.	
<b>400 (192)</b>	0,80	115 1016		415 1016		3515 1016 *	
<b>333 (153)</b>	0,80	115 1021		415 1021		3515 1021	
<b>280 (127)</b>	0,80	115 1035		415 1035		3515 1035	
<b>250 (105)</b>	0,80	115 1041		415 1041		3515 1041 *	



\*) Available while supplies last

Dimensions are given in accordance with EN 612 (corresponding diameters in brackets)



**Box expansion element, length 260 mm**

size mm	thickness mm	CLASSIC walzblank		prePATINA blaugrau		prePATINA schiefergrau	
		art. no.		art. no.		art. no.	
400 (150)	0,80	-	-	415 2012		-	-
333 (120)	0,80	115 2027		415 2027		3515 2027	



**Plug-in outlet for halfround gutter**

size mm	CLASSIC walzblank		prePATINA blaugrau		prePATINA schiefergrau	
	art. no.		art. no.		art. no.	
400 (192) / 120	113 2240		413 2240		3513 2240 *	
333 (153) / 100	113 2241		413 2241		3513 2241	
333 (153) / 120	113 2151		413 2151		-	-
280 (127) / 100	113 2094 *		-	-	-	-
280 (127) / 80	113 2041		413 2041		3513 2041	
250 (105) / 80	113 2061		413 2061		3513 2061 *	



**Outlet for box gutter and round downpipe**

size mm	CLASSIC walzblank		prePATINA blaugrau		prePATINA schiefergrau	
	art. no.		art. no.		art. no.	
400 (150) / 120	-	-	413 2301 plug-in		-	-
333 (120) / 100	113 2314 plug-in		413 2314 plug-in		3513 2314 plug-in	
200 (70) / 60	113 2348 plug-in *		413 2348 plug-in *		-	-
200 (70) / 60	113 2549 spigot *		-	-	-	-

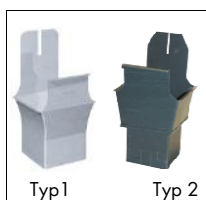

**Plug-in outlet for box gutter and box downpipe**

size mm	CLASSIC walzblank		prePATINA blaugrau		prePATINA schiefergrau	
	art. no.		art. no.		art. no.	
400 (150) / 120	-	-	413 2283 Typ 2		-	-
333 (120) / 100	113 2281 Typ 1		413 2281 Typ 1		3513 2282 Typ 2	



**Hopper head, standard type**

diameter mm	size mm	CLASSIC walzblank		prePATINA blaugrau		prePATINA schiefergrau	
		art. no.		art. no.		art. no.	
120	240×240	113 2701		413 2701		3513 2701 *	
100	220×220	113 2716		413 2716		3513 2716	
80	220×220	113 2722		413 2722		3513 2722	

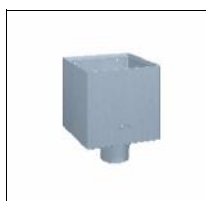

**Water head Kubus**

diameter mm	size mm	CLASSIC walzblank		prePATINA blaugrau		prePATINA schiefergrau	
		art. no.		art. no.		art. no.	
100	300×300	113 2789		413 2789		-	-
100	200×200	113 2788		413 2788		3513 2788	
80	200×200	-	-	413 2786		3513 2786	

**Halfround corner, external, 90°**

size mm	thickness mm	CLASSIC walzblank		prePATINA blaugrau		prePATINA schiefergrau	
		art. no.		art. no.		art. no.	
<b>400 (192)</b>	0,80	111 4327		411 4327		3511 4327 *	
<b>333 (153)</b>	0,70	111 5319		411 5319		3511 5319	
<b>280 (127)</b>	0,70	111 5323		411 5323		3511 5323	
<b>250 (105)</b>	0,70	111 5338		411 5338		3511 5338 *	

**Halfround corner, internal, 90°**

size mm	thickness mm	CLASSIC walzblank		prePATINA blaugrau		prePATINA schiefergrau	
		art. no.		art. no.		art. no.	
<b>400 (192)</b>	0,80	111 4346		411 4346		3511 4346 *	
<b>333 (153)</b>	0,70	111 5357		411 5357		3511 5357	
<b>280 (127)</b>	0,70	111 5361		411 5361		3511 5361	
<b>250 (105)</b>	0,70	111 5376		411 5376		3511 5376 *	

**Box corner, external, 90°**

size mm	thickness mm	CLASSIC walzblank		prePATINA blaugrau		prePATINA schiefergrau	
		art. no.		art. no.		art. no.	
<b>400 (150)</b>	0,80	-	-	411 5401		-	-
<b>333 (120)</b>	0,70	111 5410		411 5410		3511 5410	
<b>200 (70)</b>	0,65	111 5421 *		411 5412 *		-	-

**Box corner, internal, 90°**

size mm	thickness mm	CLASSIC walzblank		prePATINA blaugrau		prePATINA schiefergrau	
		art. no.		art. no.		art. no.	
<b>400 (150)</b>	0,80	-	-	411 5431		-	-
<b>333 (120)</b>	0,70	111 5440		411 5440		3511 5440	
<b>200 (70)</b>	0,65	111 5451 *		411 5442 *		-	-

**Halfround stop end, left**

size mm	CLASSIC walzblank		prePATINA blaugrau		prePATINA schiefergrau	
	art. no.		art. no.		art. no.	
<b>400 (192)</b>	113 1011		413 1011		3513 1011 *	
<b>333 (153)</b>	113 1026		413 1026		3513 1026	
<b>280 (127)</b>	113 1031		413 1031		3513 1031	
<b>250 (105)</b>	113 1045		413 1045		3513 1045 *	

**Halfround stop end, right**

size mm	CLASSIC walzblank		prePATINA blaugrau		prePATINA schiefergrau	
	art. no.		art. no.		art. no.	
<b>400 (192)</b>	113 1079		413 1079		3513 1079 *	
<b>333 (153)</b>	113 1083		413 1083		3513 1083	
<b>280 (127)</b>	113 1098		413 1098		3513 1098	
<b>250 (105)</b>	113 1102		413 1102		3513 1102 *	



\*) Available while supplies last

Dimensions are given in accordance with EN 612 (corresponding diameters in brackets)



**Box stop end, left**

size mm	CLASSIC walzblank		prePATINA blaugrau		prePATINA schiefergrau	
	art. no.		art. no.		art. no.	
400 (150)	-	-	413 1318		-	-
333 (120)	113 1322		413 1322		3513 1322	
200 (70)	113 1341 *		413 1341 *		-	-



**Box stop end, right**

size mm	CLASSIC walzblank		prePATINA blaugrau		prePATINA schiefergrau	
	art. no.		art. no.		art. no.	
400 (150)	-	-	413 1361		-	-
333 (120)	113 1375		413 1375		3513 1375	
200 (70)	113 1394 *		413 1394 *		-	-



**Round pipe elbow 72°**

size mm	CLASSIC walzblank		prePATINA blaugrau		prePATINA schiefergrau	
	art. no.		art. no.		art. no.	
150	113 3105 *		413 3105 *		-	-
120	113 3271		413 3271		3513 4291 *	
100	113 3272		413 3272		3513 3272	
80	113 3274		413 3274		3513 3274	
60	113 3276		-	-	-	-



**Round pipe elbow 60°**

size mm	CLASSIC walzblank		prePATINA blaugrau		prePATINA schiefergrau	
	art. no.		art. no.		art. no.	
150	-	-	413 3001 *		-	-
120	113 3014		413 3014		3513 4290 *	
100	113 3029		413 3262		3513 3262	
80	113 3266		413 3266		3513 3266	
60	113 3071 *		413 3265 *		-	-

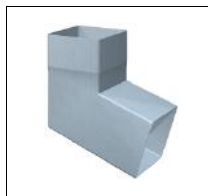

**Box pipe elbow**

size mm / angle	CLASSIC walzblank		prePATINA blaugrau		prePATINA schiefergrau	
	art. no.		art. no.		art. no.	
100/72°	113 3295		413 3295		3513 3295	



**Round offset, throat 60 mm**

size mm	length mm	CLASSIC walzblank		prePATINA blaugrau		prePATINA schiefergrau	
		art. no.		art. no.		art. no.	
120	268	113 3306		413 3306		-	-
100	240	113 3301		413 3301		3513 3301	
80	220	113 3303		413 3303		-	-



**Round pipe branch 60°**

size mm	CLASSIC walzblank		prePATINA blaugrau		prePATINA schiefergrau	
	art. no.		art. no.		art. no.	
120/100	113 4270		-	-	-	-
100/100	113 4271		413 4272		-	-

**Round pipe water diverter, with leaf trap**

size mm	CLASSIC walzblank		prePATINA blaugrau		prePATINA schiefergrau	
	art. no.		art. no.		art. no.	
120	113 4651		413 4651		3513 4652 *	
100	113 4666		413 4666		3513 4666	
80	113 4685		413 4685		3513 4653	

**Round pipe cover sleeve, with standpipe collar**

size mm	CLASSIC walzblank		prePATINA blaugrau		prePATINA schiefergrau	
	art. no.		art. no.		art. no.	
120	113 4901		413 4901		3513 4901 *	
100	113 4902		413 4902		3513 4902	
80	113 4904		413 4904		3513 4904	

**Round pipe socket**

size mm	CLASSIC walzblank		prePATINA blaugrau		prePATINA schiefergrau	
	art. no.		art. no.		art. no.	
120	113 3451		413 3451		3513 3451 *	
100	113 3452		413 3452		3513 3452	
80	113 3454		413 3454		3513 3454	
60	113 3456 *		413 3456 *		-	-

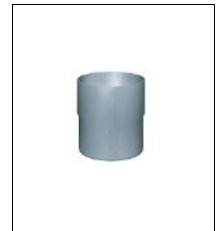
**Round pipe standpipe collar**

size mm	CLASSIC walzblank		prePATINA blaugrau		prePATINA schiefergrau	
	art. no.		art. no.		art. no.	
120 / 150	113 4575		413 4575		-	-
120 / 180	113 4518		413 4518		-	-
100 / 116	113 4613		413 4613		3513 4613	
100 / 150	113 4537		413 4537		-	-
80 / 116	113 4632		413 4632		3513 4632	
80 / 150	113 4556		413 4556		-	-

**Round downpipe bracket, made of RHEINZINK, with two threaded nuts; wall plug excluded**

size mm	CLASSIC walzblank		prePATINA blaugrau		prePATINA schiefergrau	
	art. no.		art. no.		art. no.	
150	135 4233 *		435 4233 *		-	-
120	135 4232		435 4232		3535 4232 *	
100	135 4231		435 4231		3535 4231	
80	135 4229		435 4229		3535 4229	
60	135 4227 *		435 4227 *		3535 4216 *	

**Box downpipe bracket, made of RHEINZINK, with three threaded nuts; wall plug excluded**

size mm	CLASSIC walzblank		prePATINA blaugrau		prePATINA schiefergrau	
	art. no.		art. no.		art. no.	
120	-	-	433 6910		-	-
100	133 6908		433 6908		3533 6908	



\*) Available while supplies last

Dimensions are given in accordance with EN 612 (corresponding diameters in brackets)



Halfround gutter bracket, RHEINZINK wrapped, S/S

size mm	width × th. mm	CLASSIC walzblank		prePATINA blaugrau		prePATINA schiefergrau	
		art. no.		art. no.		art. no.	
400 (192)	25×6	135 1071		435 1071		3535 1143 *	
333 (153)	25×6	135 1084		435 1084		3535 1141	
280 (127)	25×6	135 1099		435 1099		3535 1133	
250 (105)	25×6	135 1103		435 1103		3535 1132 *	



Halfround gutter bracket, galvanized steel (N = nose i.e. hook, S = spring i.e. tongue)

size mm	width × thickness mm	N/S		S/S	
		art. no.		art. no.	
400 (192)	30×5	133 5032		133 5233	
333 (153)	30×5	133 5047		133 5248	
280 (127)	30×5	133 5051		133 5252	
250 (105)	25×4	133 5085		-	-



Fascia board, halfround gutter hanger, RHEINZINK wrapped, N/S

size mm	width × thickness mm	prePATINA blaugrau		prePATINA schiefergrau	
		art. no.		art. no.	
333 (153)	30×5	433 5100		3533 5100	
280 (127)	30×4	433 5101		3533 5101	



Fascia board, halfround gutter hanger, galvanized steel, N/N

size mm	width × thickness mm	with standing seam distance	
		art. no.	
333 (153)	30×4	833 5100	833 5122
280 (127)	30×4	833 5101	833 5121
250 (105)	25×4	833 5102	833 5120



Box gutter bracket, RHEINZINK wrapped, S/S

size mm	CLASSIC walzblank		prePATINA blaugrau		prePATINA schiefergrau	
	art. no.		art. no.		art. no.	
400 (150)	-	-	435 1200		-	-
333 (120)	135 1201		435 1201		3535 1201	



Fascia board, box gutter hanger, RHEINZINK wrapped, N/S

size mm	width × thickness mm	prePATINA blaugrau		prePATINA schiefergrau	
		art. no.		art. no.	
400 (150)	30×4	433 5126		-	-
333 (120)	30×4	433 5125		3533 5125	

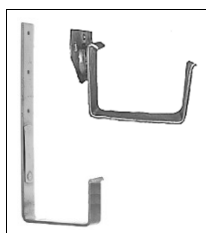

Box gutter bracket/hanger, galvanized steel (N = nose i.e. hook, S = spring i.e. tongue)

size mm	width × th. mm	rafter based N/S		fascia board N/N		fascia board N/N with standing seam distance	
		art. no.		art. no.		art. no.	
400 (150)	30×4	833 6121		-	-	-	-
333 (120)	30×4	833 6120		833 5125		833 5130	

**Snap lock halfround gutter bracket, aluminium**

size mm	CLASSIC walzblank		prePATINA blaugrau		prePATINA schiefergrau	
	art. no.		art. no.		art. no.	
<b>333 (153)</b>	-	-	993 5003		993 5012	
<b>280 (127)</b>	-	-	993 5005		993 5013	



**Snap-lock fixing rail, aluminium (C-shape)**

length mm	cross-section, mm	art. no.	
<b>3000</b>	48×18	993 6003	

**Water butt connector, with GARDENA ½" valve and 1" hose**

size mm	CLASSIC walzblank		prePATINA blaugrau		prePATINA schiefergrau	
	art. no.		art. no.		art. no.	
<b>100</b>	113 4696		413 4696		3513 4696	
<b>80</b>	113 4695		413 4695		3513 4695	



**Half bead**

size mm	CLASSIC walzblank		prePATINA blaugrau		prePATINA schiefergrau	
	art. no.		art. no.		art. no.	
<b>120</b>	113 4317		413 4317		3513 4317 *	
<b>100</b>	113 4321		413 4321		-	-
<b>80</b>	113 4337		413 4337		-	-



**Round pipe reducer**

size mm	CLASSIC walzblank	
	art. no.	
<b>100 - 60</b>	113 4280	



**Leaf guard for halfround gutter**

size mm	length mm	CLASSIC walzblank	
		art. no.	
<b>333 (153)</b>	2000	111 8002	
<b>280 (127)</b>	2000	111 8001	

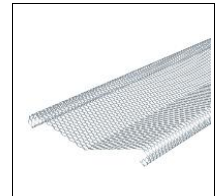

**Bolt for pipe brackets, galvanized steel**

size mm	art. no.	
<b>300</b>	835 4219	
<b>200</b>	135 4218	
<b>100</b>	135 4217	

carton 50 pcs.



**Universal downpipe bracket**

bolt length mm	art. no.	
<b>200</b>	939 9051	

with the lightning protection attachment

carton 20 pcs.



\*) Available while supplies last

Dimensions are given in accordance with EN 612 (corresponding diameters in brackets); gutter bracket - EN 1462



**Gutter heating** incl. fixing material

length m	art. no.
10	1993 5101
15	1993 5102
20	1993 5103



**Gutter adhesive RHEINZINK**

cartridge ml	art. no.
310	980 0280
carton 12 pcs.	

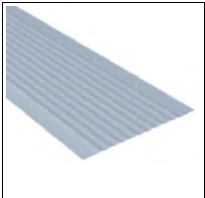

**UDS-connector, corrugated**

size mm	CLASSIC walzblank	
	art. no.	
0,80 × 250 × 3 000	114 0091	
0,80 × 333 × 3 000	114 0090	

ASK FOR FREE SAMPLES AND BROCHURES

COMING SOON

 **GRANUM EXTRA**

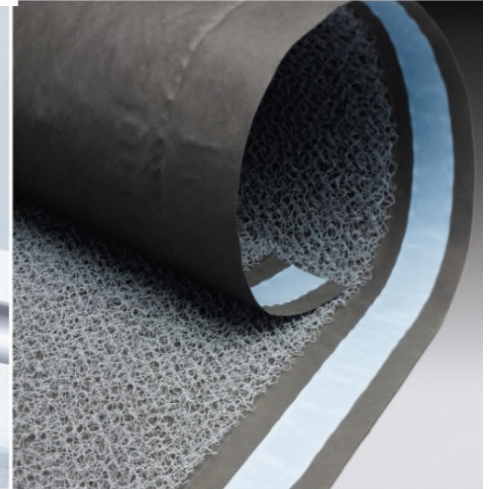

## ROOF SYSTEM ACCESSORIES

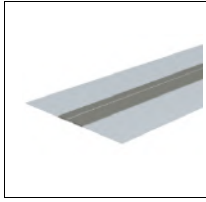

**Coiled expansion element**

	CLASSIC walzblank	
size	art. no.	
<b>3000×375×0,70</b>	115 3004	
box 12 m		



**Seam sealing tape**

length	art. no.	
m		
18	180 0278	
carton 11 pcs.		



**Sliding clip CLIPFIX,**  
stainless steel, standard height

type	art. no.	
S	1413 5064	
box 150 pcs.		



**Fixed clip CLIPFIX,**  
stainless steel, standard height

type	art. no.	
S	1413 5014	
box 300 pcs.		

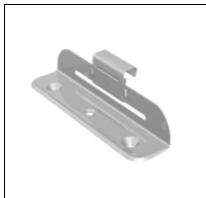

**Sliding clip CLIPFIX,**  
stainless steel, high (for structured underlays, 31 mm)

type	art. no.	
H	1413 5065	
box 150 pcs.		



**Sliding clip CLIPFIX, stainless steel, high,**  
(for structured underlays, 31 mm)

type	art. no.	
H	1413 5015	
box 300 pcs		



**Magazin screwdriver - RHEINZINK-CLIPFIX 2.0**

*Note: the price is not subject to standard discounts \**

art. no.		
939 9062		
The set includes the magazine, 2 batteries, charger and magazine attachment with the special tool		



**CLIPFIX screw, e-coating**  
(incl. a bit)

size	art. no.	
mm		
4×30	939 9058	
box 500 pcs.		



**CLIPFIX screw, collated, stainless steel**

size	art. no.	
mm		
4×30	1439 9056	
box 1000 pcs.		



**CLIPFIX screw, collated, e-coating**

size	art. no.	
mm		
4×30	939 9059	
box 1000 pcs.		



**Spare parts CLIPFIX 2.0\***

item	art. no.	
special tool attachment	989 8013	
screwdriver bit	989 8009	



**CLIPFIX 2.0 magazine attachment\*,**  
incl. the special tool

art. no.		
989 8014		

**AIR-Z** - structured underlay

width mm	coil length m	thickness mm	package volume m <sup>2</sup>	art. no.
1000	75	8	75	980 0284

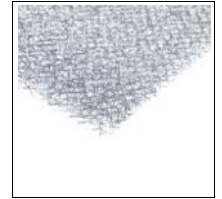
**VAPOZINC** - structured underlay with vapour permeable insulation

width mm	coil length m	thickness mm	package volume m <sup>2</sup>	art. no.
1400	30	8	45	980 0285

effective covering area 42 m<sup>2</sup>

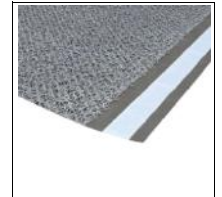
**Powerslate mono RHEINZINK-PV\***, length 1640 mm

*Note: prices are not subject to standard discounts*

spacing between seams mm	power / number of PV cells / weight	art. no.
530	150 W / 30 / ≈9,5 kg	980 0095
430	100 W / 20 / ≈7,5 kg	980 0096

**RHEINZINK-PV clamp\***

material	carton	art. no.
aluminium with EPDM	100 pcs.	2139 9933

Non-standard items, available on request

**Solder rod lead free SnZn-801**

type	art. no.
Sn 91% Zn 9%	980 0269

10 pcs. ≈ 1,80 kg  
carton ≈ 18 kg

**Solder bar LC-40**

type	art. no.
Pb 60% Sn 40%	980 0251

10 pcs. ≈ 2,65 kg  
carton ≈ 25 kg

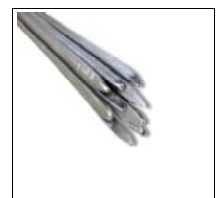
**Solder liquid PowerSurface**

vessel	art. no.
750 ml ≈ 1 kg	980 0139

carton 15 pcs.

**Solder liquid (flux) ZD-pro**

vessel	art. no.
750 ml ≈ 1 kg	980 0212

carton 15 pcs.

**SWEEPER - cleaning liquid**

vessel	art. no.
1000 ml ≈ 1 kg	180 0232

carton 6 pcs.



\* ) Not standard articles, available on request



**Soft zinc**, for flashings, pleated

thickness × width mm	length m	CLASSIC walzblank	
		art. no.	
<b>0,60×333</b>	<b>15</b>	514 5904	
<b>0,60×250</b>	<b>20</b>	514 4005	



**Soft zinc**, for flashings, flat

thickness × width mm	length m	CLASSIC walzblank	
		art. no.	
<b>0,60×450</b>	<b>12</b>	514 4000	
<b>0,60×333</b>	<b>15</b>	514 4001	



**Ridge finish seam**

size mm	CLASSIC walzblank	prePATINA blaugrau		prePATINA schiefergrau	
	art. no.	art. no.		art. no.	
65/65	113 5002	413 5002		3513 5002	

material thickness: 0,65 mm

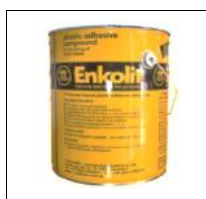

**ENKOLIT adhesive compound**

bucket gross capacity kg	efficiency kg/m <sup>2</sup>	art. no.	
<b>11</b>	2-3	980 0264	

pallet 45 pcs.



**ENKOLIT adhesive compound**, cartridge

cartridge capacity ml	efficiency kg/m <sup>2</sup>	art. no.	
<b>310</b>	2-3	980 0265	

carton 12 pcs.



**ENKE VORANSTRICH 933** - primer for ENKE products

bucket gross capacity kg	efficiency kg/m <sup>2</sup>	art. no.	
<b>2,5</b>	100-200	980 0004	
<b>20</b>	100-200	980 0036	



**ENKE MultiProtect** - sheet metal protection product

bucket gross capacity kg	efficiency kg/m <sup>2</sup>	for prePATINA blaugrau		for prePATINA schiefergrau	
		art. no.		art. no.	
<b>4</b>	200	980 0001		9800040	
<b>12</b>	200	980 0005*		-	-

\*) Available while supplies last



**Snowguard tube CEDA\***, length 2 m - certified system

material	diameter/thickness mm	natural version		painted version	
		index		index	
aluminium	30/2	AL0010		AL0010-P	

bulk packing 10 pcs.

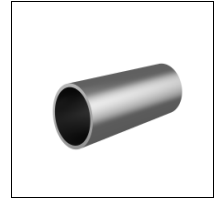

**Snowguard clamp, single pipesystem CEDA\***, for standing seam, screws A2 - certified system

material	diameter/thickness mm	natural version		painted version	
		index		index	
aluminium	30/2	AL0001A2		AL0001A2-P	

carton 10 pcs.



**Snowguard clamp, double pipesystem CEDA\***, for standing seam, screws A2 - certified system

material	diameter/thickness mm	natural version		painted version	
		index		index	
aluminium	30/2	AL0002A2		AL0002A2-P	

carton 10 pcs.

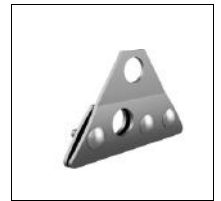

**Tube stoppage CEDA\***, screw A2 - certified system

material	diameter/thickness mm	natural version		painted version	
		index		index	
aluminium	30/2	AL0015A2		AL0015A2-P	

carton 50 pcs.



**Snowguard tube connector\*** - certified system

material		index	
PVC		AL0016	

carton 40 pcs.

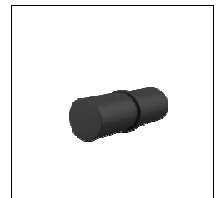

**Tube plug CEDA\*** - certified system

material	index	
PVC	AL0017	

carton 100 pcs.



\*) Not standard articles, available on request



**Roof walking grating clamp holder CEDA\***, for standing seam, screws A2, in accordance with EN-516-1 standard

material	type	natural version		painted version	
		index		index	
aluminium	A 5-30° pitch	AL1001A2		AL1001A2-P	
aluminium	N 20-50° pitch	AL1002A2		AL1002A2-P	

carton 16 pcs.



**Roof walking grating CEDA\***, in accordance with EN-516-1 standard

size	material	natural version		painted version	
		index		index	
670	aluminium	AL2006		AL2006-P	
1000	aluminium	AL1210		AL1210-P	
1340	aluminium	AL2013		AL2013-P	
2000	aluminium	AL2020		AL2020-P	

bulk packing 2 pcs.

**Snowguard tube REES, length 3 m**

diameter/thickness mm	material	art. no.	
32/2	aluminium	139 9945	

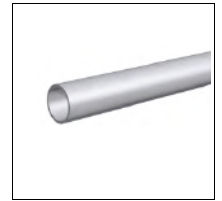

**Snowguard clamp REES, single pipesystem, for standing seam**

type	material	art. no.	
double standing seam	aluminium	139 9951	
angle standing seam	aluminium	139 9964	

carton 10 pcs.



**Snowguard clamp REES, double pipesystem, for standing seam**

carton	material	art. no.	
10 pcs.	aluminium	139 9979	



**Heightening element for snowguard clamp**

carton	material	art. no.	
20 pcs.	aluminium	139 9931	



**Ice guard REES**

carton	material	art. no.	
50 pcs.	aluminium	139 9983	



**Snowguard tube connector REES, 32/2 mm**

carton	material	art. no.	
50 pcs.	PVC	139 9944	



\*) Not standard articles, available on request



**Roof walking grate clamp holder REES\***, for standing seam, for gratings from 250 to 300 mm wide, in accordance with EN-516-1 stand.

type	material	index
0-40° pitch	aluminium	2139 9995 LA-1650
0-40° pitch	stainless steel	1439 9994 LA-1652

Stainless steel nuts and screws are included  
No grating fixing agraffes included (see further items)

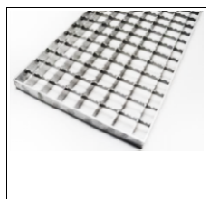

**Roof walking grate, lattice REES\***, loop 30x30 mm, height 25 mm, thickness 2 mm, no fixing elements; in accordance with EN-516-1 stand.

size mm	material	index
600x250	galvanized steel	LA-1210
800x250	galvanized steel	LA-1211
1600x250	galvanized steel	LA-1212
800x250	stainless steel	LA-1263
1600x250	stainless steel	LA-1267



**Agraffe REES\***, for fixing gratings

	material	index
	galvanized steel	LA-1235
	stainless steel	LA-1279



**Roof sheet steel walking grate REES\***, in accordance with EN-516-1 standard, fixing nuts and screws are included

size mm	material	index
600x250	galvanized steel	LA-1216
800x250	galvanized steel	LA-1220
1500x250	galvanized steel	LA-1223
3000x250	galvanized steel	LA-1227

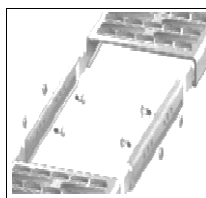

**Connector REES\*** for roof sheet steel walking grate

	material	index
	galvanized steel	LA-1231
	stainless steel	LA-1274



**Solar holder\*** for standing seam

size mm	material	index
60x40	aluminium	LA-1416
100x40	aluminium	LA-1417
60x40	stainless steel	LA-1436
100x40	stainless steel	LA-1437

\*) Not standard articles, available on request.

Please ask the technical advisors and RHEINZINK distributors for further details

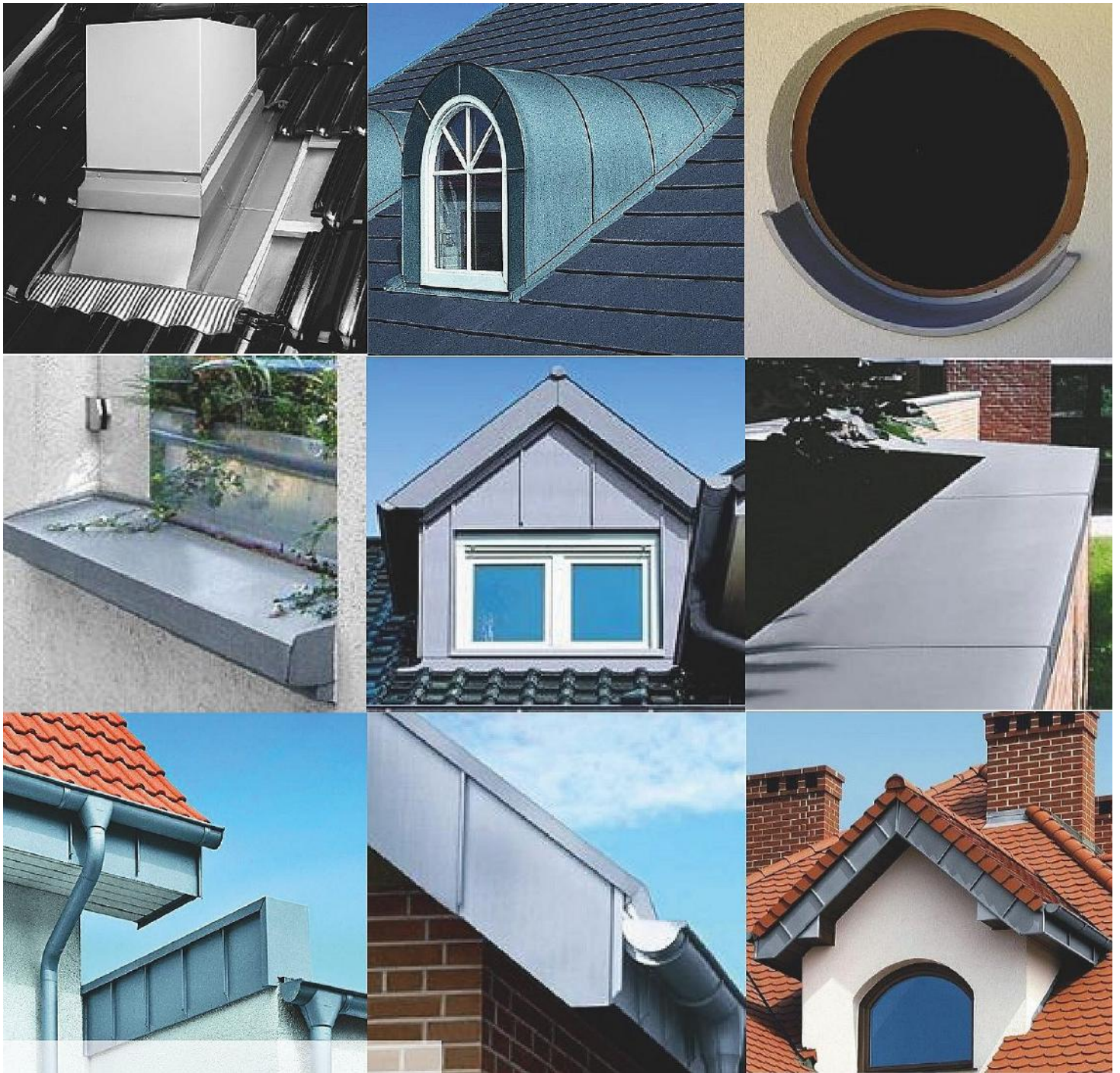

## ARCHITECTURAL DETAILS AND FLASHINGS

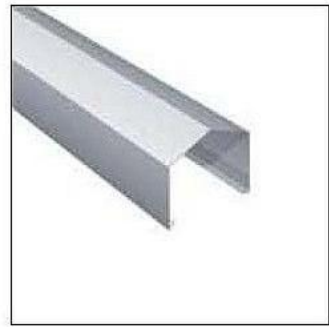
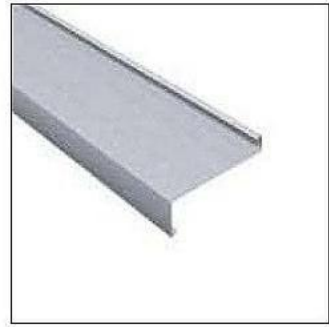
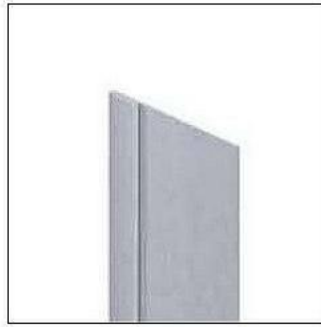
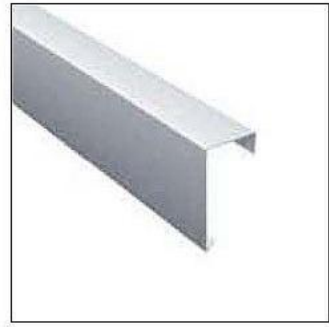
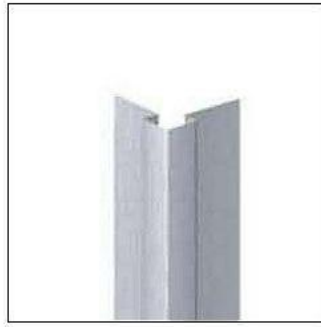
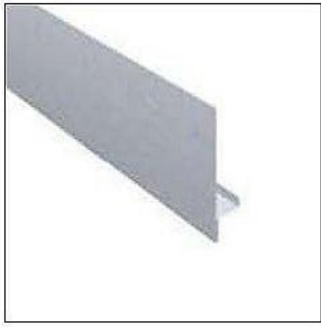
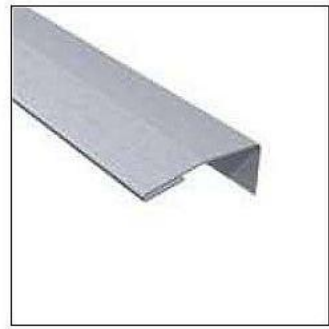
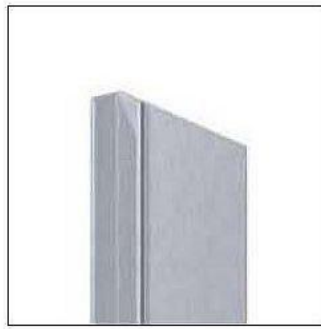

**CHIMNEY FLASHINGS**

**Prefabricated chimney flashing set** for tiles, 15°-55°; 4-part set

length of chimney, mm	width of chimney, mm	application	prePATINA blaugrau	
			art. no.	
up to 550	up to 550	roof slope	413 2962	



**Soft zinc**, for flashings, pleated

thickness × width × length mm	CLASSIC walzblank	
	art. no.	
0,60×333×15000	514 5904	
0,60×250×20000	514 4005	



**Soft zinc**, for flashings, flat

thickness × width × length mm	CLASSIC walzblank	
	art. no.	
0,60×450×12000	514 4000	
0,60×333×15000	514 4001	



**PREFABRICATED STANDING SEAM PROFILES**

**Standing seam profile\*** with notches and folds or standard form (straight cut), nominal length from 0,40 m unfolded  
- examples of standard widths given

width		CLASSIC walzblank		prePATINA blaugrau		prePATINA schiefergrau with film	
coil mm	panel mm	art. no.		art. no.		art. no.	
670	600	114 3519		414 3519		3614 3519	
600	530	114 3504		414 3504		3614 3504	
500	430	114 3561		414 3561		3614 3561	

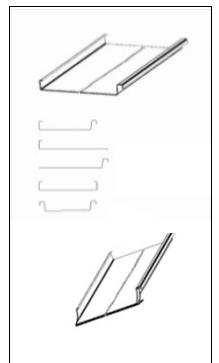

\*) prices are subject to individual calculation, also for other non-standard widths - see further PROFILING SERVICES

**PROFILING SERVICES**

**Standing seam profiling services**

- width: according to standard delivery program of RHEINZINK coils and sheets
- panels length: 400-4500 mm

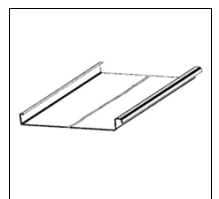

**Notching of standing seam panels**

- with or without folding:

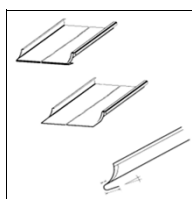

**Arc bending of standing seam panels**

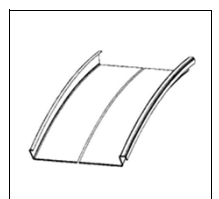







## FAÇADE SYSTEMS

- 1 Diamond Tiles
- 2 Flat Lock Tiles
- 3 Square Tiles

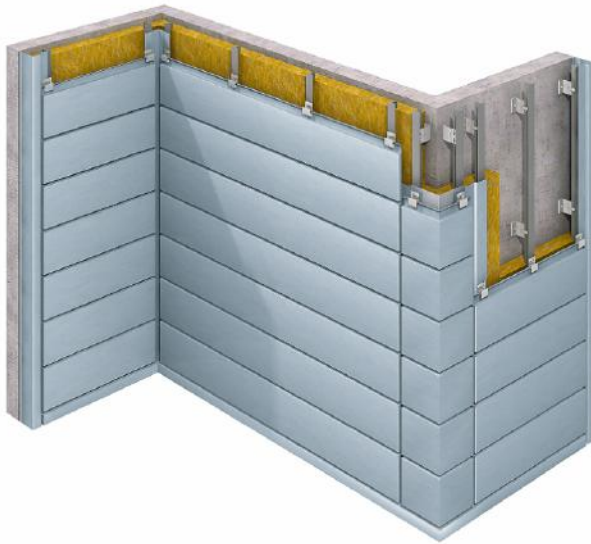
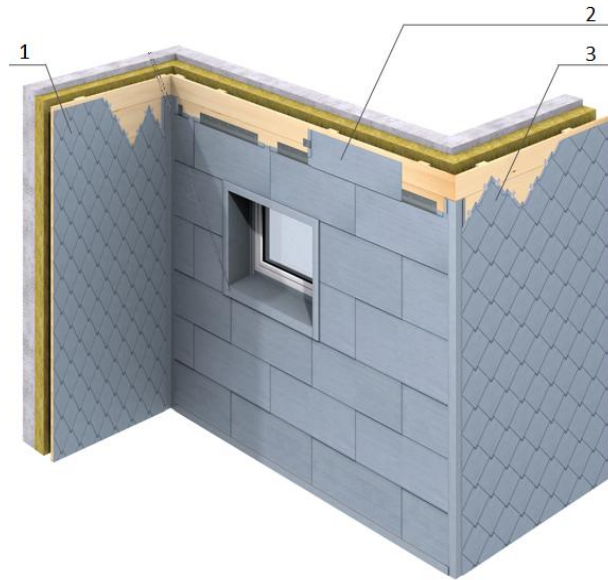

Horizontal Panels HZ

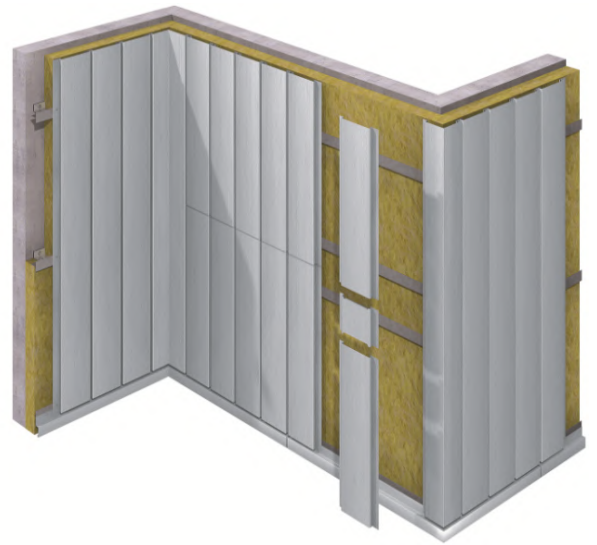

Reveal Panels SF



SP-Line Panels



Standing Seam Profile

**Square tile RHEINZINK, incl. 2 fixing clips**

edge length mm	efficiency pcs./m <sup>2</sup>	CLASSIC walzblank			prePATINA blaugrau			prePATINA schiefergrau		
		art. no.			art. no.			art. no.		
350×350	10	115 6037			415 6037			3515 6037		
283×283	15	115 6041			415 6041			-	-	-
200×200	33	115 6056			415 6056			-	-	-
material thickness: 0,70 mm										

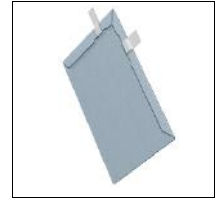

**Diamond tile RHEINZINK, incl. 2 fixing clips**

diagonals mm	efficiency pcs./m <sup>2</sup>	CLASSIC walzblank			prePATINA blaugrau			prePATINA schiefergrau		
		art. no.			art. no.			art. no.		
406×263	20	115 6003			415 6003			-	-	-
330×228	28	115 6018			415 6018			-	-	-
223×168	53	115 6022			415 6022			-	-	-
material thickness: 0,70 mm										

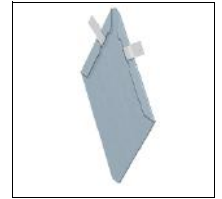

**Flat lock tile**

CLASSIC walzblank	prePATINA blaugrau	prePATINA schiefergrau
thickness 0,70 -0,80 mm	thickness 0,70 -0,80 mm	thickness 0,70 -0,80 mm
standard nominal size /visible edge length:		
333×600 / 283×550 mm, 500×1000 / 450×950 mm, 600×1200 / 550×1150 mm		

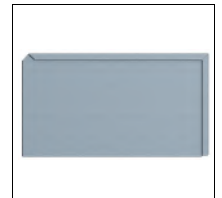

**Roof soffit SP-Line panel, including fixing elements**

thickness mm	width mm	length mm	covering area m <sup>2</sup>	bulk packing pcs.	weight kg/m <sup>2</sup>	prePATINA blaugrau		
						art. no.		
0,70	350	3000	1,05	3	7,20	413 6401		
the whole system calculation - on request								

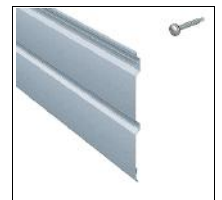

**Reveal panel SF, no stop-ends, adjustable shadow joint 0-30 mm, panel axial width = visible panel's part + 2 × ½ of a joint**

prePATINA blaugrau	prePATINA schiefergrau
thickness: 0,80 -1,00 mm	thickness: 0,80 -1,00 mm
width: 200 - 333 mm	
standard length: 3 or 4 m, others on request	

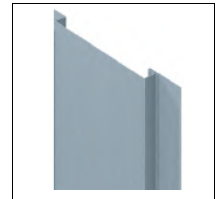

**Horizontal panel HZ, no stop-ends, fixed shadow joint 20 mm, panel axial width = visible panel's part + 2 × ½ of a joint**

prePATINA blaugrau	prePATINA schiefergrau
thickness: 1,00 -1,20 mm	thickness: 1,00 -1,20 mm
width: 200 - 333 mm	
standard length: 3 or 4 m, others on request	

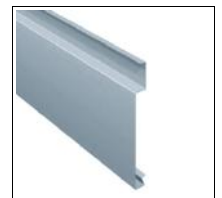

**Standing seam profile with notches and folds or standard form (straight cut)**

CLASSIC walzblank	prePATINA blaugrau	prePATINA schiefergrau
recommended thickness: 0,80 mm	recommended thickness: 0,80 mm	recommended thickness: 0,80 mm
standard profile width: 330, 430, 530, 600 mm		
max. length of standard prefabricated profiles: 4 m (other length on request)		

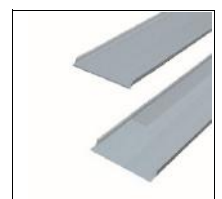



**VAPOwall** - wind-insulation for facade cladding

width mm	bale length m	weight g/m <sup>2</sup>	bale covering area m <sup>2</sup>	art. no.
1500	50	150	75	980 0286
UV resistance - 12 weeks				



**Fastening rail for horizontal panels HZ**

length mm	material	art. no.
2000	aluminium	939 9000



**Fixing clip** for square and diamond tile

material	art. no.
stainless steel	1415 6002
carton 500 pcs.	



PERFORATED PROFILES AND MESH

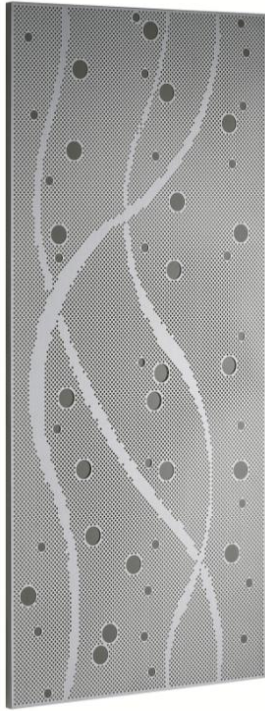

*Optical effects obtained by combining two types of patina, 5, 10 and 20 mm perforation and the combination of a perforated and a full sheet surface*



*Variation in the form of rectangular and square perforated coffers and square perforated coffers arranged in a pattern*



*A cut round structure - a combination of holes of different sizes*



*Structuring by any laser-cut forms - interesting effects obtained thanks to back lighting*



*The possibility of arranging the motifs regardless of the division of the facade*



**PERFORATED SHEETS (LATTICE)**

Available in sheet or panel shapes. Limit dimensions and thicknesses:

CLASSIC walzblank	prePATINA blaugrau	prePATINA schiefergrau
thickness 0,70-1,50 mm	thickness 0,70-1,50 mm	thickness 0,70-1,20 mm
width up to 1 m		
length up to 4 m		

**MESH**

Available in sheet or panel shapes. Limit dimensions and thicknesses:

CLASSIC walzblank	prePATINA blaugrau	prePATINA schiefergrau
material thickness 0,80-1,50 mm	material thickness 0,80-1,50 mm	material thickness 0,80-1,20 mm
width up to 1 m		
length up to 4 m		

Designs and prices to be agreed with the sales department and advisers of RHEINZINK Polska.



walzblank



blaugrau

schiefergrau

**RHEINZINK-CLASSIC**

Natural zinc surface zinc in its original form

**RHEINZINK-prePATINA ECO ZINC**

The world's only natural surface with self-healing patina



granite

basalte



**RHEINZINK-PRISMO brushed white+**

Innovative titanium zinc surface with elegant white finish





## SHEETS AND COILS



**RHEINZINK sheets**, length 2000 mm; full pallet ≈ 1000 kg

thickness mm	width mm	CLASSIC walzblank			prePATINA blaugrau			prePATINA schiefergrau filmed		
		art. no.			art. no.			art. no.		
0,60	1000	150 5018			-	-	-	-	-	-
0,65	1000	150 6014			450 6014			-	-	-
0,70	1000	150 7011			450 7011			3650 7011		
0,80	1000	150 9013			450 9013			3650 9013		
1,00	1000	151 3012			451 3012			-	-	-

3000 mm long and more than 1,00 mm thick sheets are available on request  
weight of 1 m<sup>2</sup> of 1 mm thick sheet ≈ 7,20 kg

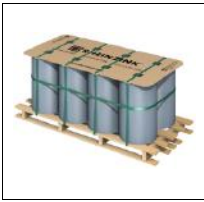

**RHEINZINK coils**, á 100 kg; full pallet ≈ 800 kg or 600 kg

thickness mm	width mm	CLASSIC walzblank			prePATINA blaugrau			prePATINA schiefergrau filmed		
		art. no.			art. no.			art. no.		
0,70	1000	164 0365			464 0365			3664 0365		
0,70	400-670*	by size			by size			by size		
0,80	1000	165 0275			465 0275			3665 0275		
0,80	400-670*	by size			by size			by size		

\*) coils standard sizes: 400, 500, 600, 670, 1000 mm; others on request



**RHEINZINK coils**, á 1000 kg

thickness mm	width mm	CLASSIC walzblank			prePATINA blaugrau			prePATINA schiefergrau z foliá		
		art. no.			art. no.			art. no.		
0,70	1000	164 0011			464 0011			3664 0067		
0,70	500-670*	by size			by size			by size		
0,80	1000	165 0011			465 0011			3665 0034		
0,80	500-670*	by size			by size			by size		
1,00	1000	167 0009			467 0009			3667 0046		
1,00	500-670*	by size			by size			by size		

\*) coils standard sizes: 400, 500, 600, 670, 1000 mm; others on request

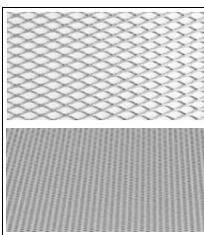

**Diamond mesh AERO**, sheet size 1000 × 2000 mm

thickness mm	perforation	CLASSIC walzblank			prePATINA blaugrau			prePATINA schiefergrau		
		art. no.			art. no.			art. no.		
1,00	63%	159 8500			-	-	-	-	-	-
1,00	46%	159 8000			459 8000			3559 8000		



**Sheets and coils RHEINZINK GRANUM, PRISMO**

For more information please refer to [www.rheinzink.pl](http://www.rheinzink.pl) and RHEINZINK sales representatives



**RHEINZINK-GRANUM  
EXTRA**

Modern design of matt  
surface titanium-zinc

**COMING SOON**



















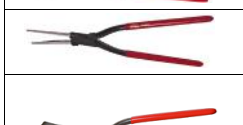

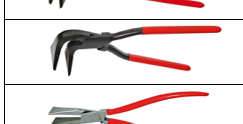

**RHEINZINK-PRISMO  
brushed white+**

Innovative titanium zinc  
surface with elegant  
white finish



PROFILING MACHINES AND SHEET METAL TOOLS

	art. no.	article name	producer	producer index	
	990 1293	Curved tin snips, left <i>Rundlochscherer links</i> 250 mm	STUBAI	267702	
	990 1294	Curved tin snips, right <i>Rundlochscherer rechts</i> 250 mm	STUBAI	267701	
	990 1301	Pelikan pattern snips <i>Durchlaufschere PVC</i> 350 mm	STUBAI	269011	
	990 1300	Pelikan pattern snips <i>Durchlaufschere</i> 350 mm	STUBAI	269001	
	990 1315	Combination tin snips, left <i>Kombi Blechscherer links</i> 280 mm	STUBAI	270501	
	990 1316	Combination tin snips, right <i>Kombi Blechscherer rechts</i> 280 mm	STUBAI	270001	
	990 1314	Combination tin snips, left <i>Kombi Blechscherer links PVC</i> 280 mm	STUBAI	270511	
	990 1317	Combination tin snips, right <i>Kombi Blechscherer rechts PVC</i> 280 mm	STUBAI	270011	
	990 1318	Combination tin snips with lever, right <i>KombiBlechscherer übersetzt rechts</i> 260 mm	STUBAI	270101	
	990 1313	Combination tin snips with lever, left <i>Kombi Blechscherer übersetzt links</i> 260 mm	STUBAI	270601	
	990 1191	Gutter pliers <i>Wulsten-Beißzange</i> 250 mm	STUBAI	279101	
	990 1144	Seam opening pliers <i>Falzaufbiegezange eingelegt PVC</i> 250 mm	STUBAI	279501	
	990 1820	Flat nose pliers, box joint <i>Flachzange DG PVC</i> 240 mm	STUBAI	280001	
	990 1821	Flat nose pliers, lap joint <i>Flachzange eingelegt PVC</i> 240 mm	STUBAI	280501	
	990 1215	Round nose pliers, box joint <i>Rundzange DG PVC</i> 240 mm	STUBAI	281001	
	990 1181	Seaming pliers, straight, box joint <i>Falzzange gerade DG PVC</i> 18 mm	STUBAI	282001	
	190 1179	Seaming pliers, straight, box joint <i>Falzzange gerade DG PVC</i> 60 mm	STUBAI	282002	
	190 1180	Seaming pliers, straight, lap joint <i>Falzzange gerade eingelegt PVC</i> 60 mm	STUBAI	282051	
	990 1167	Seaming pliers, box joint <i>Falzzange DG 45° PVC</i> 18 mm	STUBAI	282101	
	990 1168	Seaming pliers, box joint <i>Falzzange DG 45° PVC</i> 60 mm	STUBAI	282102	
	990 1164	Seaming pliers, lap joint <i>Falzzange eingelegt 45° PVC</i> 60 mm	STUBAI	282151	
	190 1159	Seaming pliers, box joint <i>Falzzange DG 90° PVC</i> 60 mm	STUBAI	282201	
	990 1160	Seaming pliers, lap joint <i>Falzzange eingelegt 90° PVC</i> 60 mm	STUBAI	282251	
	990 1165	Seaming pliers, piccolo, lap joint <i>Falzzange leicht gerade eing. PVC</i> 24/180 mm	STUBAI	282901	
	990 1166	Seaming pliers, piccolo, lap joint <i>Falzzange leicht eingelegt 45°</i> 20/180 mm	STUBAI	283001	

art. no.	article name	producer	producer index		
190 1131	Corner seaming pliers <i>Eck-Falzzange eingelegt PVC 60/280 mm</i>	STUBAI	282451		
990 1125	Seaming pliers, box joint <i>Quetschfalzzange gerade DG PVC 80 mm</i>	STUBAI	282801		
990 1055	Eaves gutter pliers, lap joint <i>Dachrinnenzange beschichtet PVC 15 mm</i>	STUBAI	2827 01		
990 1190	Asymmetrical pincers, polished <i>Beißzange asymmetrisch poliert PVC 250 mm</i>	STUBAI	1080 51		
990 1690	Plastic seaming piece, with handle <i>Falzstück PE weiß mit Handgriff 290x140 mm</i>	STUBAI	278850		
990 1048	Seaming pliers <i>Quetsch-Falzzeisen 800 g</i>	STUBAI	278401		
990 1384	Gutter hanger bending tool <i>Rinnenträger-Abbiegezange 600 mm</i>	STUBAI	28241 1		
190 1183	Corner seaming pliers, straight, box joint <i>Deckzange gerade DG 120 mm</i>	STUBAI	282312		
990 1187	Corner seaming pliers, straight, box joint <i>Deckzange gerade DG 180 mm</i>	STUBAI	282318		
190 1184	Seaming pliers, box joint <i>Deckzange gebogen DG 30° 160 mm</i>	STUBAI	282356		
990 1033	Roofing seamer, straight <i>Schaleisen geschmiedet 120 mm</i>	STUBAI	278001		
990 1071	Single lock seamer <i>Winkelfalzschießer 220 mm</i>	STUBAI	282412		
990 1420	Double seamer <i>Winkeldoppelfalzer 200 mm</i>	STUBAI	282415		
990 1054	Drip edge bender <i>Traufenkanter 250 mm</i>	STUBAI	282413		
990 1068	Drip edge seamer <i>Traufenschließer 200 mm</i>	STUBAI	282414		
990 1767	Marking template, hardened <i>Anreißschablone gehärtet 1,3 mm, 140x100 mm</i>	STUBAI	278601		
990 1584	Plastic faced hammer, wedge shape <i>Kunststoffhammer keilform 155x85x35</i>	STUBAI	278501		
990 1585	Plastic faced hammer, round <i>Kunststoffhammer rund 60 mm</i>	STUBAI	278506		
190 1876	Wooden hammer with metal ring jacket <i>Holzhammer mit Metallmantel 60 mm</i>	STUBAI	278516		
990 1378	Hammer with pellet <i>Kunststoffhammer mit Pellets PCV 400 g</i>	-	-		
990 1399	Hammer soldering iron <i>Loetgarnitur mit Hammerkolben 350 g</i>	PERKEO	-		
190 1398	(incl. iron tip, hose and holder <i>inkl. Kupferstück, Schläuche und Aufstellfuß</i> )				
990 1397					
990 1056	Hand hole punch <i>Handlochstanze HLS</i>	M.A.S.C.	HLS		
990 1057	Oblong hole punch <i>Handlochstanze LLZ</i>	M.A.S.C.	LLZ		
990 1960	Notcher <i>Blechknabber BK2</i>	M.A.S.C.	BK2		
190 1145	Seam opening pliers <i>Falzaufbiegezange eingelegt 80 mm FAZ</i>	M.A.S.C.	FAZ		



## MACHINES AND EQUIPMENT

RHEINZINK can offer to buy machinery and equipment:

- roller seam profilers (mobile, workshop, multi-purpose)
- arc profiling machines
- manual and mechanical sheet metal shears
- manual and mechanical press brakes, including segmented ones
- eaves edging devices ('EHA' type)
- manual devices for sheet metal profiling
- accessories for sheet metal work (trolleys for sheet metal coils, decoilers, roller shears etc.)

Individual prices to be agreed with the sales department and advisers of RHEINZINK Polska





**Technical support:**  
Marjan Borkovskij  
14207 Vilniaus raj.  
Lietuva  
M: +370 65018240  
info@rheinzink.lt

**Sales**

RHEINZINK Polska Sp. z o.o.  
Majdan, ul. Trasa Lubelska 57  
PL-05-462 Wiązowna  
T: +48 22 789 91 80  
F: +48 22 789 91 99  
zlecenia@rheinzink.pl

